



BLADE- face rigger system



S: SYSTEMS • P: C-29 • D: 5-06

BLADE face rigger system

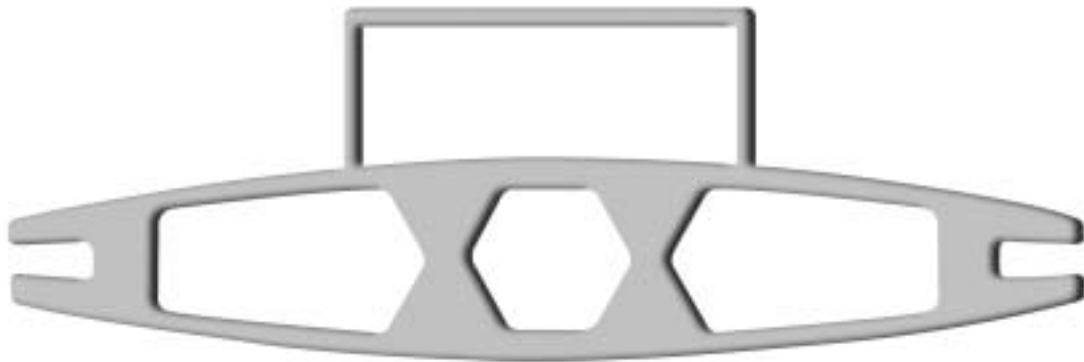

minium
SYSTEMS



FACE BLADE



S: SYSTEMS • P: C-30B • D: 5-06

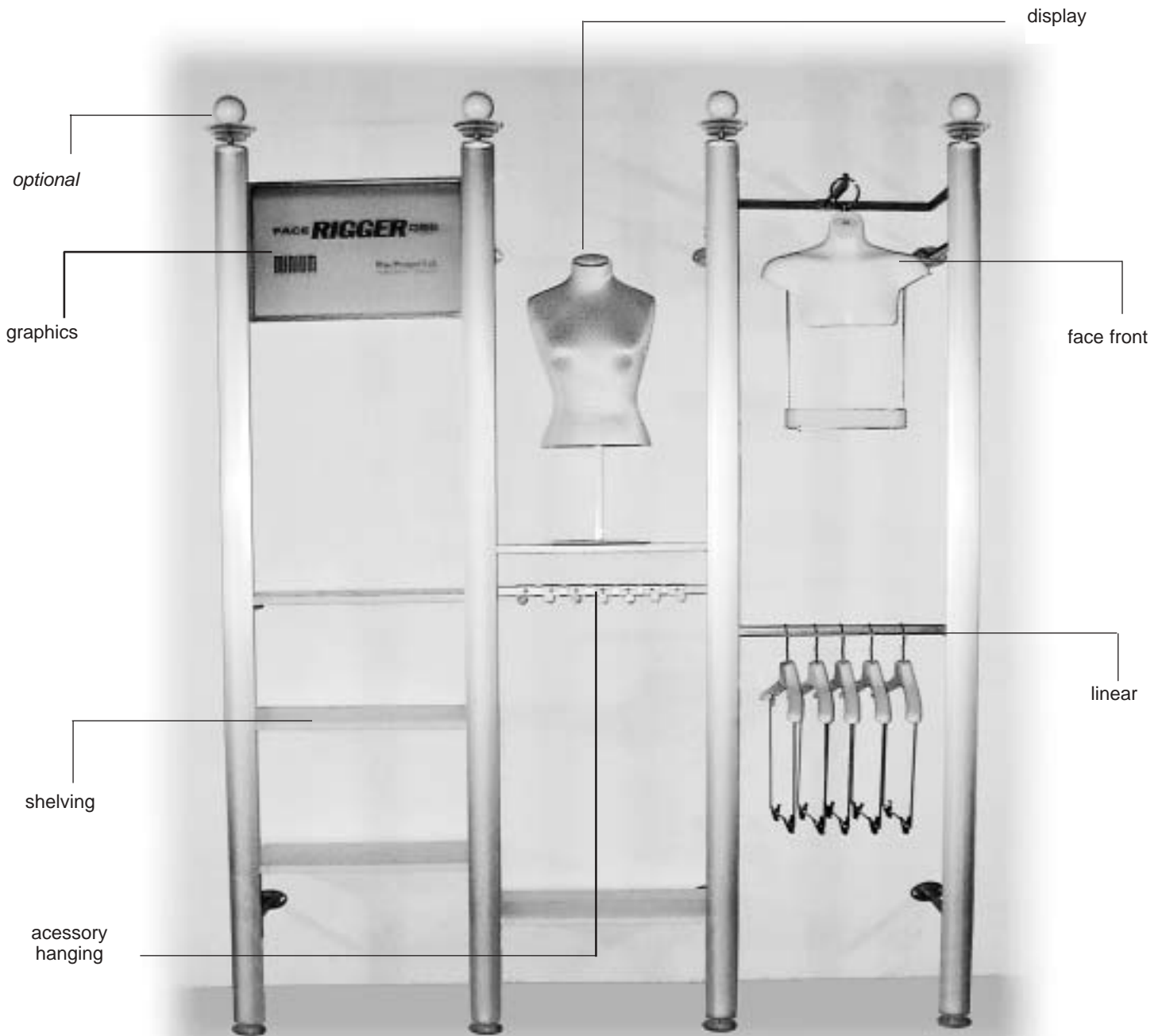

Contemporary styling is achieved by these soft elliptical aluminum BLADE FACE posts concealing functional double slotted steel standards that will accept virtually all standard hardware.



HANGING FOR FACE



S: SYSTEMS • P: C-31A • D: 5-06

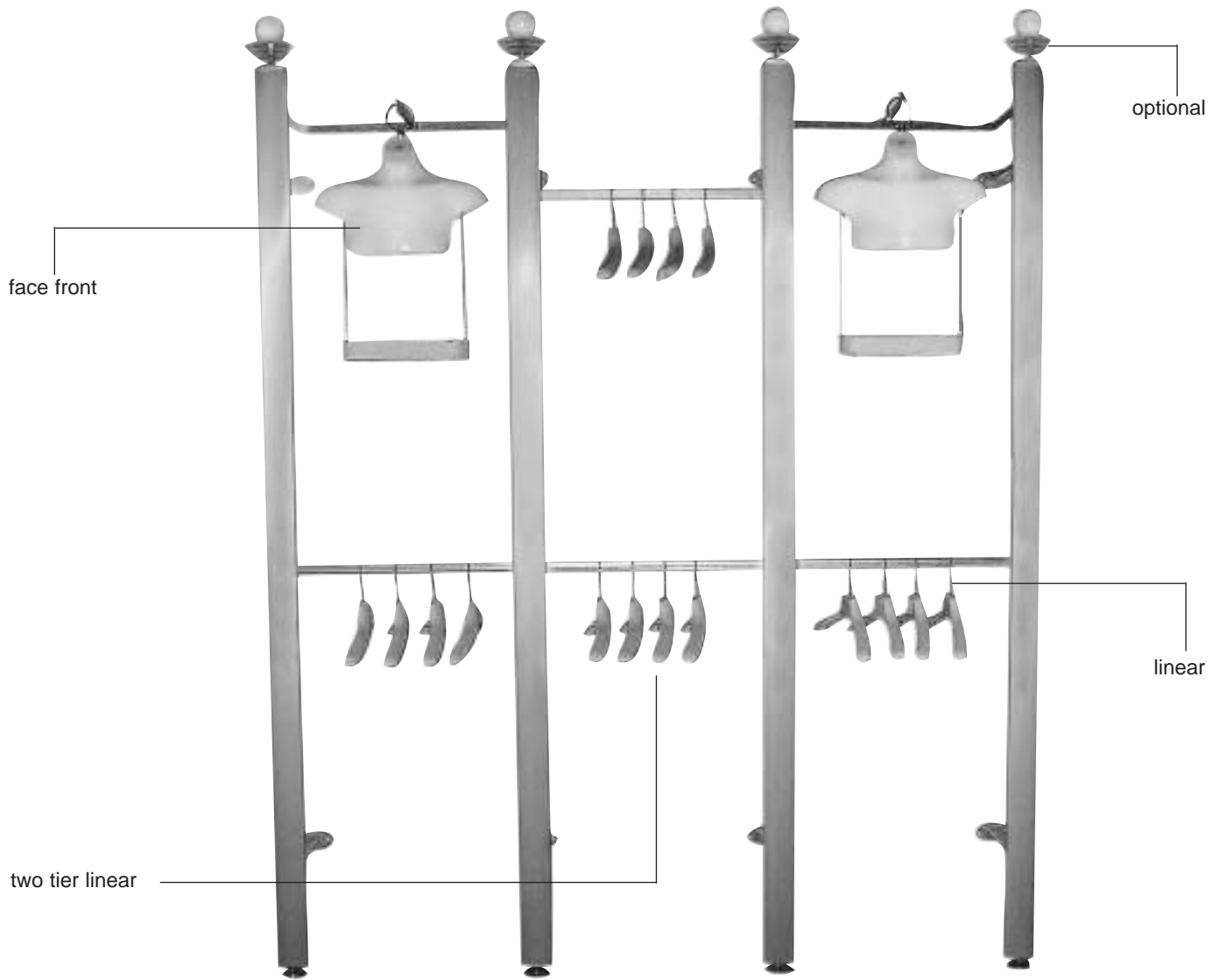

BLADE FACE RIGGERS slotted standards allow you to select functional round hangrails or versatile rectangular or square hangrails for linear or frontal presentation.



round

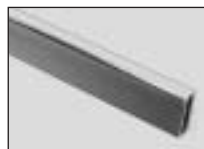

rectangular



SHELVING FOR FACE



S: SYSTEMS • P: C-31B • D: 5-06



BLADE FACE RIGGERS slotted standards allow you to select straight or angled shelf brackets which can be coupled with wood, glass or acrylic shelves in various depths and widths.

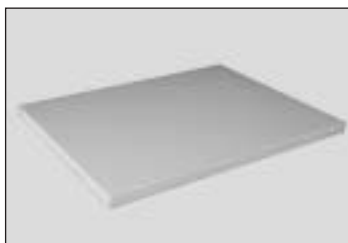

Wooden Shelf

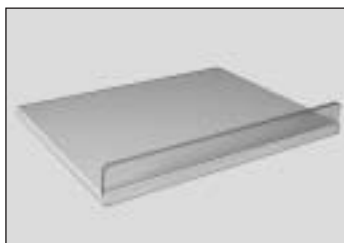

Angled Wooden Shelf
with Frosted Plastic Lip



Acrylic bin



FEATURES FOR FACE



S: SYSTEMS • P: C-32A • D: 5-06

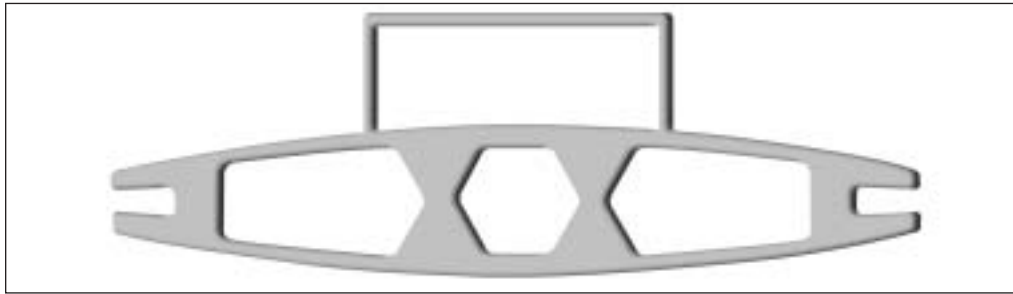

Plan view shows unique shape of elliptical post.



Rear view of outrigger shows double slotted steel standards mounted to aluminum post.



Levellers make installation easy.



FACE BLADE- components



S: SYSTEMS • P: C-32B • D: 5-06



3611
Rear view of outrigger shows double slotted steel standards mounted to aluminum post.

**FACE BLADE
DOUBLE SLOTTED
3611**
96" high x 15" deep clear anodized aluminum post with chrome standard and wall brackets.



SHELVINGS

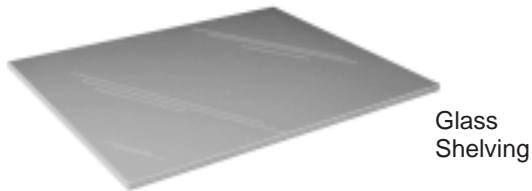

Glass Shelving

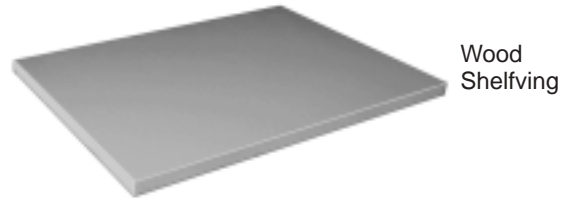

Wood Shelving



109 Rubber Shelving Protector



114 Rubber Cushion



Wood Shelving with Plastic Lip

Shelf Brackets



4064



4065



4063

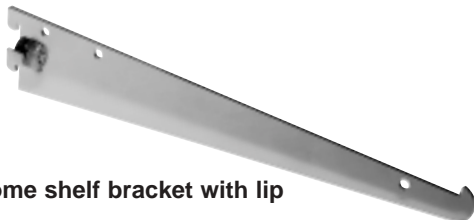

Chrome shelf bracket with lip

4665	10"	4667	14"
4666	12"	4668	16"

Brackets For Wood Shelf

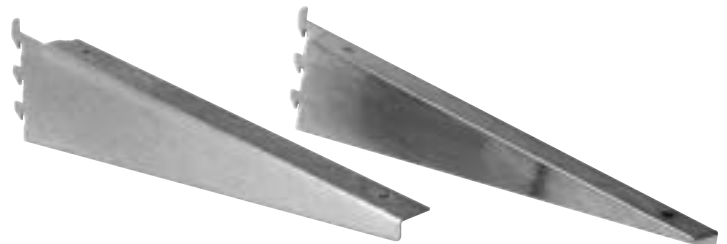

12" brackets, bright chrome finish
4410 left **4411** right



FACE BLADE- components



S: SYSTEMS • P: C-33A • D: 5-06

ALL CHROME FINISH (except specified otherwise)

Round Tubing



4691 1"
4692 1 1/4"



9513 1"
9514 1 1/4"
Metal end cap.



9516 1"
9517 1 1/4"
Metal end cap with stopper.



9511 1"
4638 1 1/4"
Metal end cap with retainer



9518
1" Plastic cap



Round Hangrail Holder
5252 1"
5253 1 1/4"

Square Tubing



4694 1"



9509
1" End Cap



Square Hangrail Holder
4670 - 2" long

Rectangular Tubing



4693
1/2" x 1 1/2"



9510
1/2" x 1 1/2" End Cap



9512 1/2" x 1 1/2" End cap,
black plastic

9523 same as above but
chrome finish



Rectangular Hangrail Holder
4549 3" long

Bar Stock



4695
3/16" x 1"

CLEARANCE

CLEARANCE



4652 4651

Left and right bar stock holders
4651 - 4652 - 1" long

CLEARANCE



5922 FaceOut
•12"

CLEARANCE



Hooks for bar stock
5917 6"
5918 9"
5919 12"



FACE BLADE- components



S: SYSTEMS • P: C-33B • D: 5-06

ALL CHROME FINISH (except specified otherwise)

OPTIONAL
FINIALS



3663
4 tier ball finial



3664
2 tier cone finial



3665
1 tier swirl finial

Square Tubing

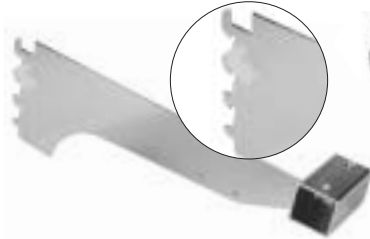

4671 - 12" long
Square Crossrail Holder



4262 12" straight



4334 5 ball waterfall

CLEARANCE 4261 7 ball waterfall



4337 3 hook waterfall

CLEARANCE 4265 5 hook waterfall

Rectangular Tubing

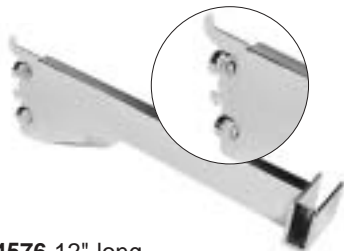

4576 12" long
Rectangular Crossrail Holder
4576B 8" long **CLEARANCE**



4493
12" straight

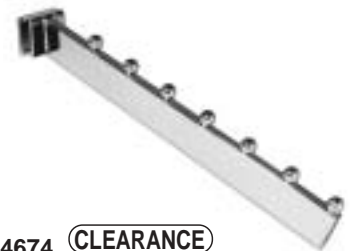

4674 **CLEARANCE**
4 ball waterfall

4491
7 ball waterfall

Rectangular Tubing



CLEARANCE
4672
16" /sign holder adaptor



Hooks with safety end
for 1/2" x 1 1/2" tubing

- 4657SE 4"
- 4658SE 6"
- 4659SE 8"
- 4660SE 9"
- 4700SE 10"
- 4701SE 12"